

Welcome to

<http://www.keys2yourhouse.com/2000-Sageleaf-Court>

2000 Sageleaf Court

in Upchurch Place



At-a-Glance

- 3 Bedrooms
- 2.5 Bathrooms
- 2-Car Garage
- Bonus Room / 4th Bedroom
- 2,305 Sq. Ft.

• **\$285,000**



This custom built home has a stunning curb appeal. Located on a large corner lot with side entry garage, charming covered front porch and private screened-in porch with a paved patio in the back, and surrounded by beautiful gardens. Adjacent to the gardens is the playground with walking trails, leading to the community pond and gazebo.

This home features an open layout with hardwood floors in the foyer, dining room and eat-in kitchen. The kitchen has stainless steel appliances, crown moldings, granite counter tops, 42" cabinets, and a large pantry. The huge master suite is on the second level, with a garden tub and separate standing shower and double vanity. Two additional bedrooms, and a bonus room which could also be a 4th bedroom with a full bathroom. The walk-up attic is ready to be finished for more play or recreation.

For more information or personal tour, **call Alexandra Glinkowski at 919-616-2719**, email alexandra@keys2yourhouse.com or go to www.keys2yourhouse.com/2000-sageleaf-court

Area Map

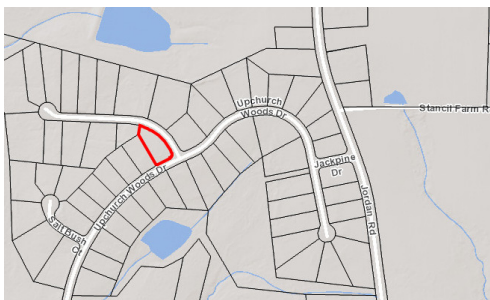

First Floor

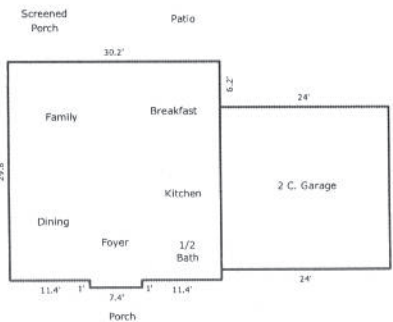

Second Floor

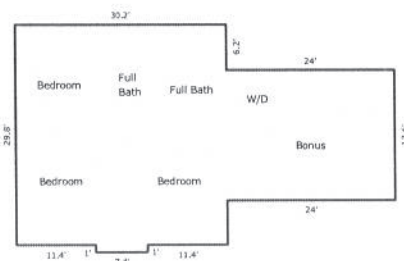

Photos

Clockwise from top left:

- 1** Master bedroom with crown ceiling and ceiling fan
- 2** Double vanity in master bathroom
- 3** Large bonus room can be used for play, recreation, or as a 4th bedroom
- 4** Endless possibilities in the roomy unfinished attic with full windows - ready for your finishing touches
- 5** Screened-in porch with ceiling fans connects to the patio
- 6** Patio overlooks the spacious yard
- 7** Granite countertops in kitchen



Alexandra Glinkowski
Broker, GRI, CRS, Realtor
EcoBroker

Re/Max United

alexandra@keys2yourhouse.com

<http://www.keys2yourhouse.com>

919-616-2719 direct

